

**DEMO BLDG LEGEND**

- A BLDG: CARPORT
- B BLDG: CARPORT
- C BLDG: MUSIC HOUSE
- D BLDG: MAINTENANCE/LAUNDRY
- E BLDG: NURSES HUT
- F BLDG: HERRICK HALL
- G BLDG: BLAKE HALL
- H BLDG: WOODWORK SHOP
- I BLDG: DAVE'S SHOP
- J BLDG: GARAGE
- K BLDG

**NON PROFIT BLDG LEGEND**

- AA BLDG: LIBRARY ANNEX
- BB BLDG: AFTER SCHOOL
- CC BLDG: OFFICE
- DD BLDG: OFFICE
- EE BLDG: OFFICE
- FF BLDG: TEACHERAGE

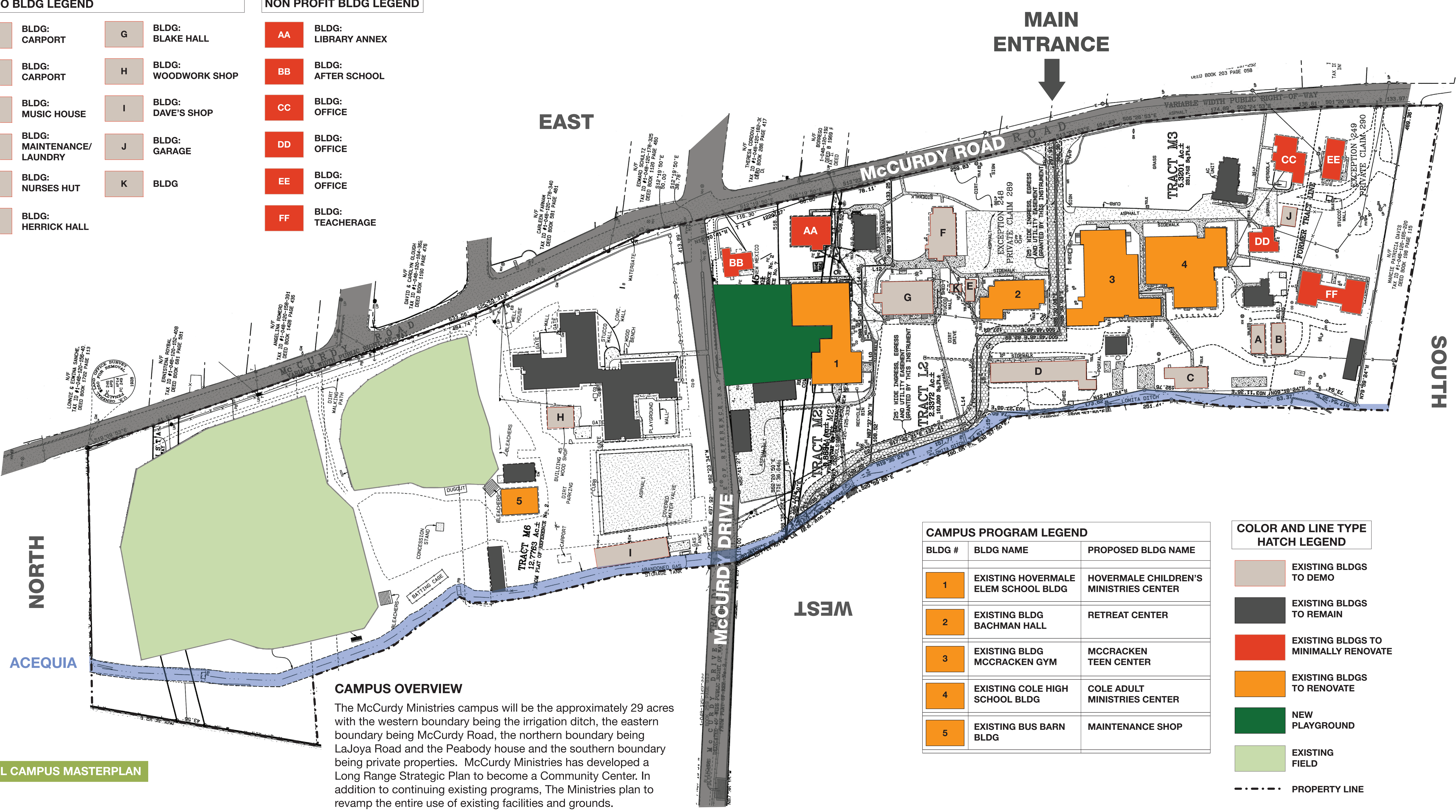

**CAMPUS OVERVIEW**

The McCurdy Ministries campus will be the approximately 29 acres with the western boundary being the irrigation ditch, the eastern boundary being McCurdy Road, the northern boundary being LaJoya Road and the Peabody house and the southern boundary being private properties. McCurdy Ministries has developed a Long Range Strategic Plan to become a Community Center. In addition to continuing existing programs, The Ministries plan to revamp the entire use of existing facilities and grounds.

**CAMPUS PROGRAM LEGEND**

BLDG #	BLDG NAME	PROPOSED BLDG NAME
1	EXISTING HOVERMALE ELEM SCHOOL BLDG	HOVERMALE CHILDREN'S MINISTRIES CENTER
2	EXISTING BLDG BACHMAN HALL	RETREAT CENTER
3	EXISTING BLDG MCCRACKEN GYM	MCCRACKEN TEEN CENTER
4	EXISTING COLE HIGH SCHOOL BLDG	COLE ADULT MINISTRIES CENTER
5	EXISTING BUS BARN BLDG	MAINTENANCE SHOP

**COLOR AND LINE TYPE HATCH LEGEND**

- EXISTING BLDGS TO DEMO
- EXISTING BLDGS TO REMAIN
- EXISTING BLDGS TO MINIMALLY RENOVATE
- EXISTING BLDGS TO RENOVATE
- NEW PLAYGROUND
- EXISTING FIELD
- PROPERTY LINE

**OVERALL CAMPUS MASTERPLAN**



MAIN CAMPUS ELEVATION



BACHMAN HALL



BACHMAN HALL



COLE & MCCRACKEN

FEBRUARY 25, 2017

**CAMPUS MASTERPLAN**  
**MCCURDY MINISTRIES**  
 ESPANOLA  
 NEW MEXICO





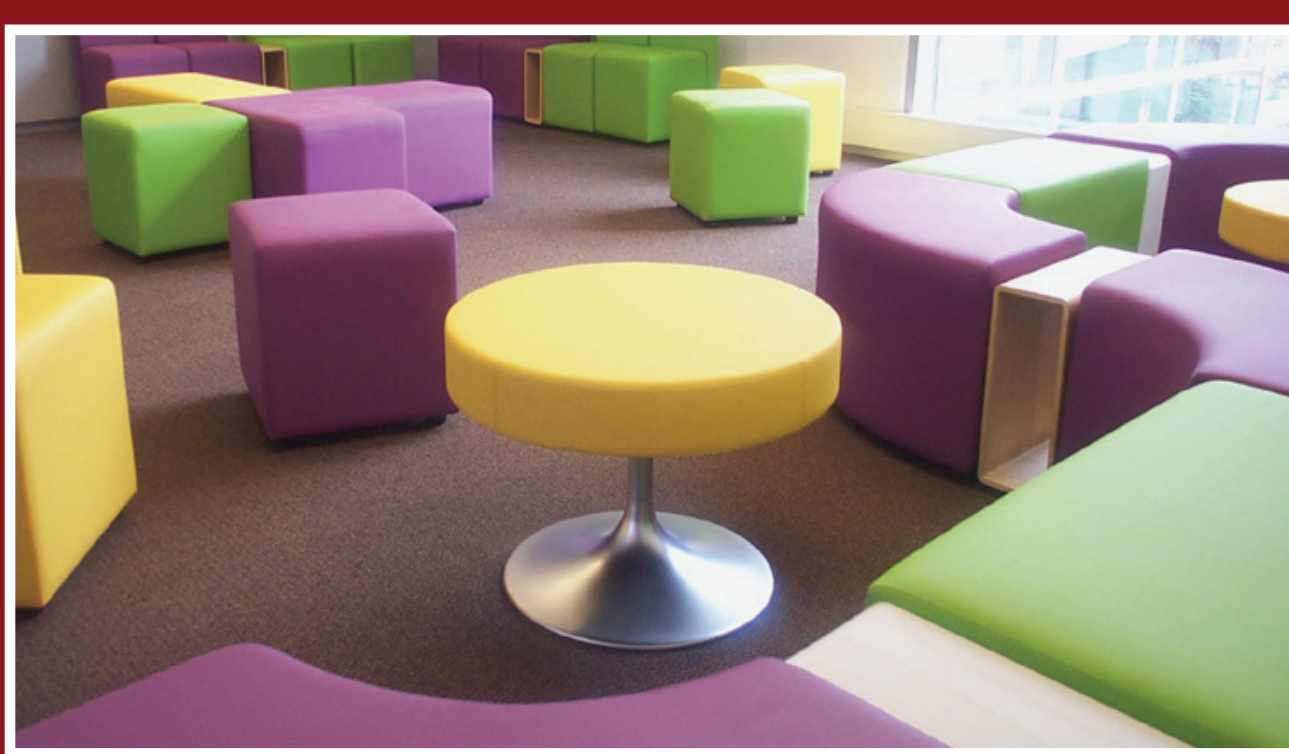

BACHMAN HALL - HOVERMALE BEYOND



HOVERMALE BUILDING

groundworkstudio

OVERALL CAMPUS LANDSCAPE MASTERPLAN

COLOR AND LINE TYPE LEGEND

- BUILDING TO BE RENOVATED
- BUILDING TO REMAIN
- NONPROFIT HUB
- GARDEN / LANDSCAPE FOCUS
- ROADWAYS / PARKING
- PROPERTY LINE
- RECREATIONAL / ATHLETICS
- ACEQUIA / LIFE GIVING FORCE
- PERIMETER TRAIL
- NEW FENCED PLAYGROUND

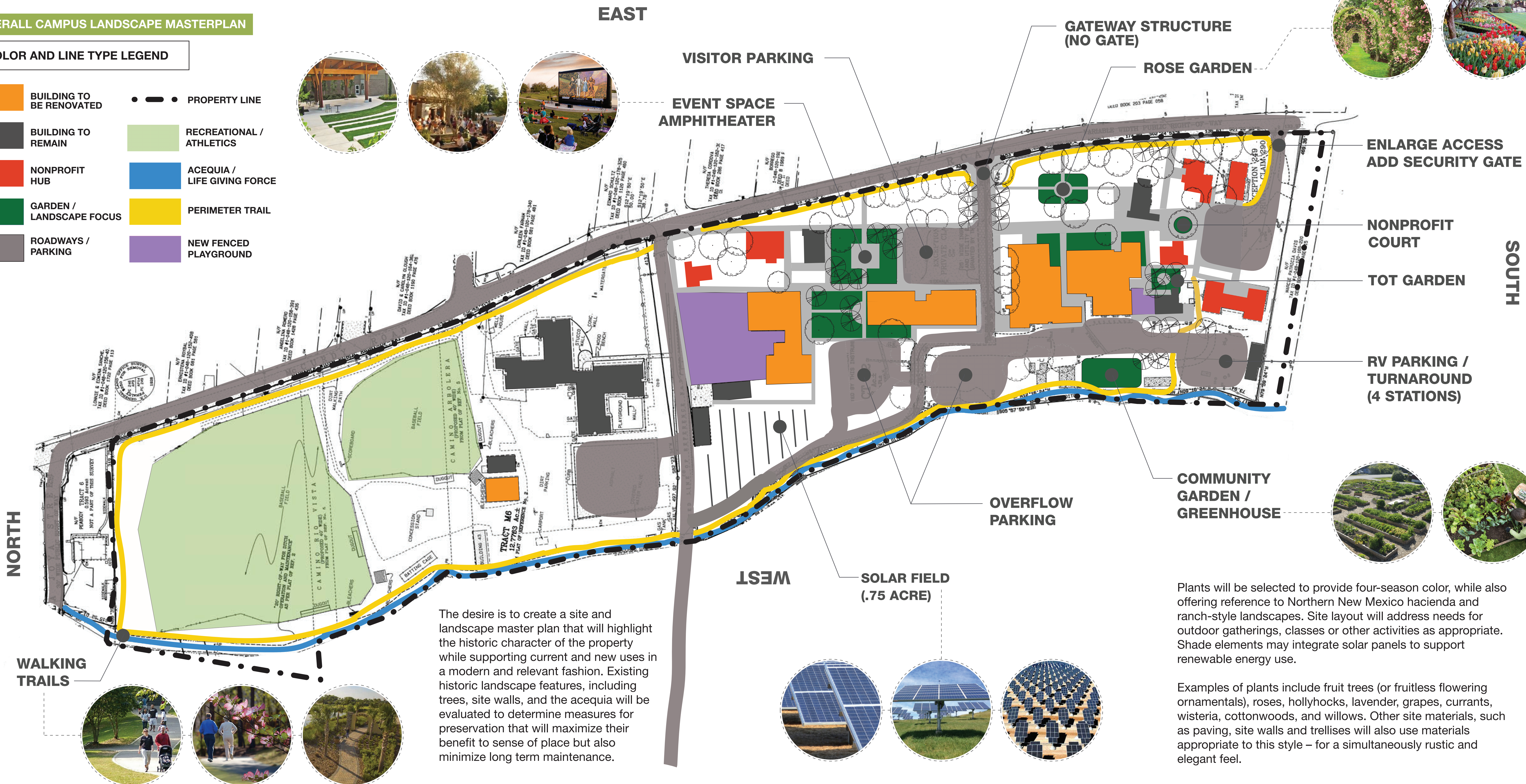

Plants will be selected to provide four-season color, while also offering reference to Northern New Mexico hacienda and ranch-style landscapes. Site layout will address needs for outdoor gatherings, classes or other activities as appropriate. Shade elements may integrate solar panels to support renewable energy use.

Examples of plants include fruit trees (or fruitless flowering ornamentals), roses, hollyhocks, lavender, grapes, currants, wisteria, cottonwoods, and willows. Other site materials, such as paving, site walls and trellises will also use materials appropriate to this style – for a simultaneously rustic and elegant feel.



HOVERMALE BUILDING



HOVERMALE BUILDING - BACHMAN HALL BEYOND